

Advent

WREATH CRAFT

ACTIVITY FOR SENIORS

Materials Needed:

- Construction Papers (Green, Purple, Blue, Pink, and Yellow)
- Glue
- Scissors
- Pencil
- Ruler

Crafting Your Own Advent Wreath

- Take the green construction paper and fold it in half. Then, fold it again from the bottom all the way to the top. You can look at the picture for help.



Advent

WREATH CRAFT

ACTIVITY FOR SENIORS

- When you unfold the paper, you'll see a line where it was folded. Use a ruler to trace along this line.

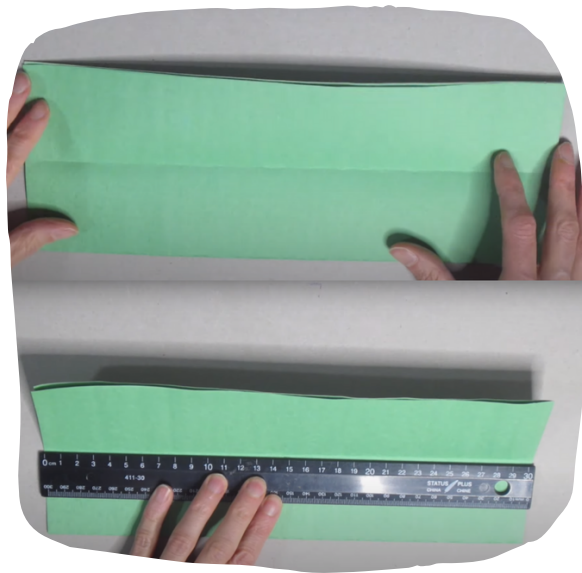

- After you've traced the fold, put a dot on every inch.



Advent

WREATH CRAFT

ACTIVITY FOR SENIORS

- On each dot, draw a line from the center fold down to the bottom. You can look at the picture for help.



- Now, when you have all your lines, carefully cut along them until you reach the fold line. Do this again for another line until you see cuts in the middle when you open the whole construction paper.

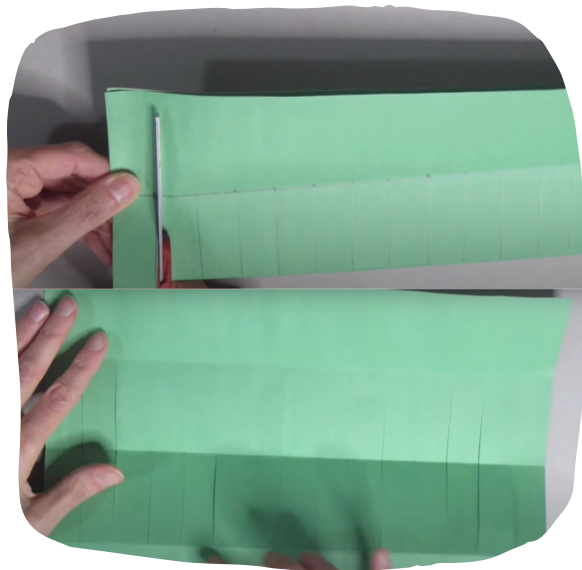



Advent

WREATH CRAFT

ACTIVITY FOR SENIORS

- Open up the whole paper and fold the bottom flap. Once it's folded, put some glue on top of the flap.



- After you've put on the glue, fold the bottom flap all the way to the top flap. Make sure they stick together.



Advent

WREATH CRAFT

ACTIVITY FOR SENIORS

- Roll up the paper and add some glue to one end. Press it together to seal it. You've made a wreath!



- Now, let's make the candles. You'll need more construction paper for this. Get purple and pink paper for the candles and yellow paper for the flames. Take the purple paper and use a ruler to trace three candles. Use the pink paper to trace one candle, making it the same height as the purple ones.

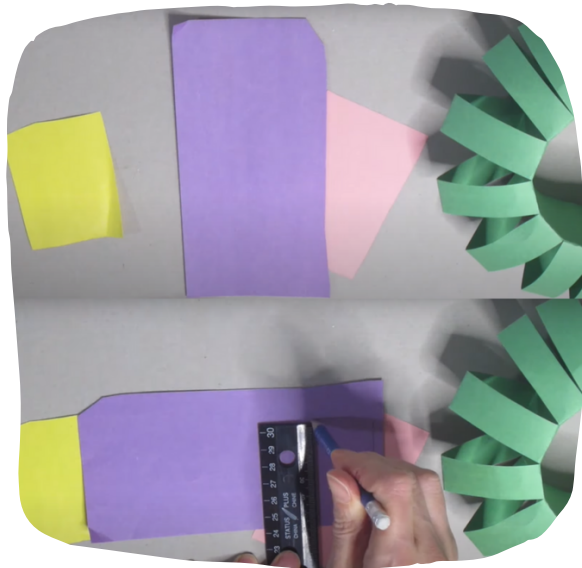



Advent

WREATH CRAFT

ACTIVITY FOR SENIORS

- Carefully cut out the candle shapes and put glue on the bottoms of each one.

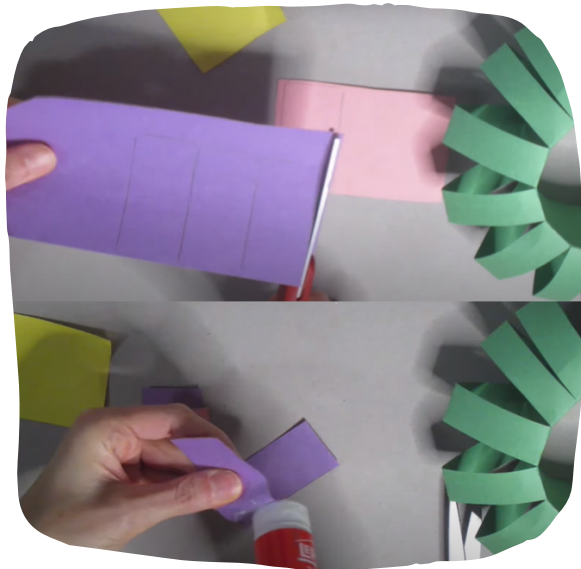

- Stick the candles onto your wreath.

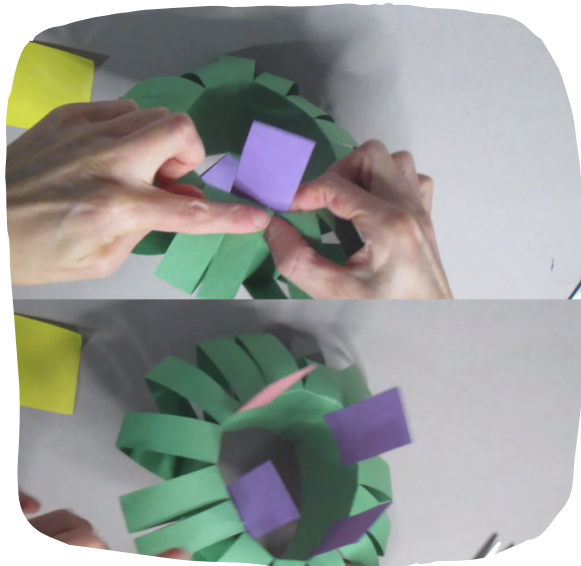

Advent

WREATH CRAFT

ACTIVITY FOR SENIORS

- Next, take a small piece of yellow paper and fold it into four sections to create four flames for the candles.

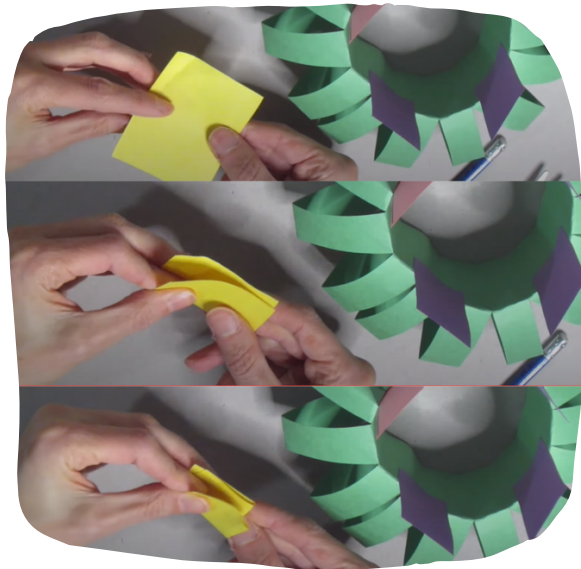

- Draw a flame shape on the folded yellow paper. Cut it out, and now you have four identical flames.

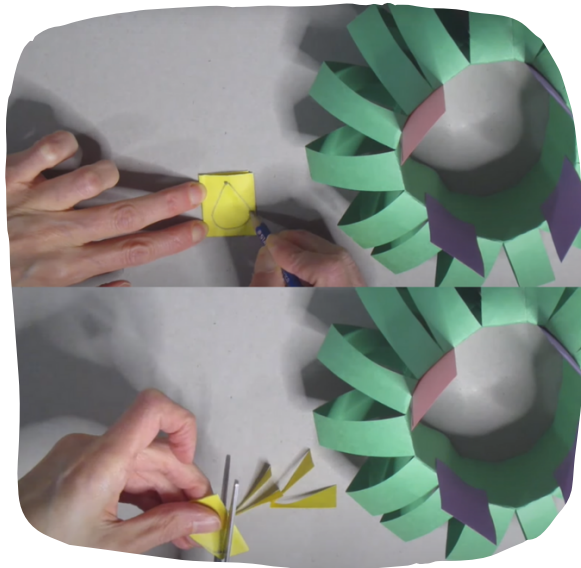

Advent

WREATH CRAFT

ACTIVITY FOR SENIORS

- During Advent, each week, glue one flame onto a candle. Start with the purple candle, then add one to the second and third purple candles, and for the last week, glue a flame onto the pink candle.

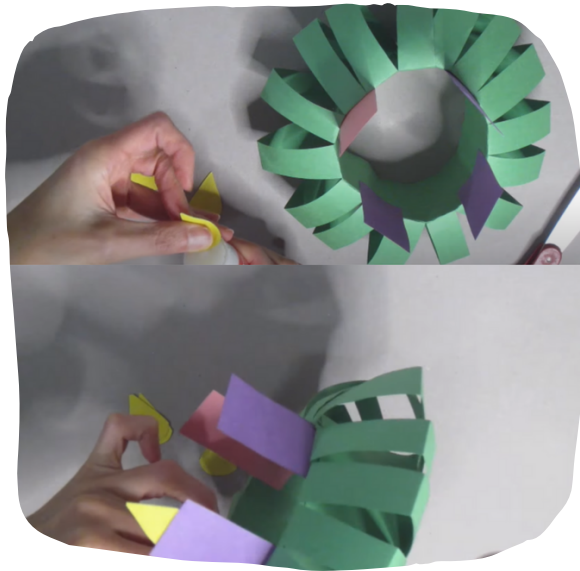

- Congratulations! You've made your very own Advent Wreath!

